

iDeaPLAY

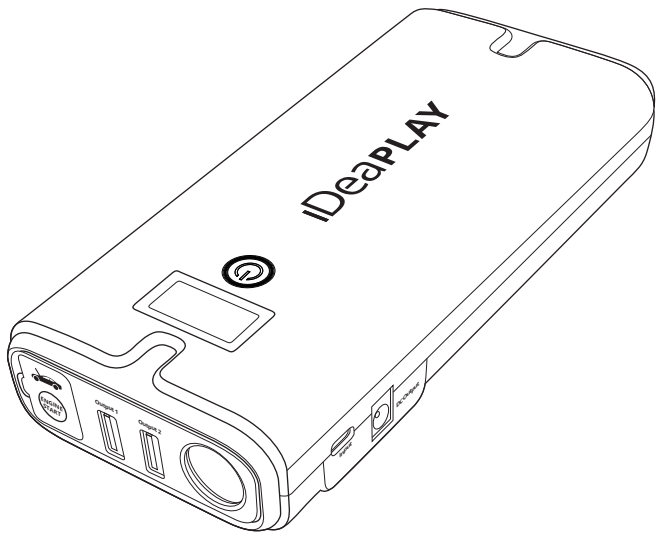

Model: J10

USER GUIDE

Portable Jump Starter

Friendly Tips

Thank you for purchasing the iDeaPlay J10 Jump Starter. Please carefully read the instruction manual and use the product correctly.

Customer Support

For any support or comments concerning our products, please send an email to: Support@ideausa.com
Toll-Free NO: +1-866-886-6878

Product Accessories ✓

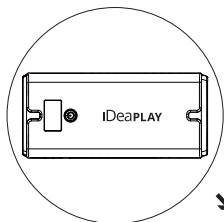

Jump Starter

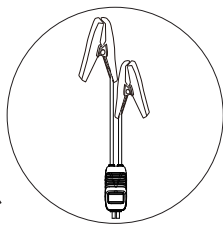

Smart Clamp Cable

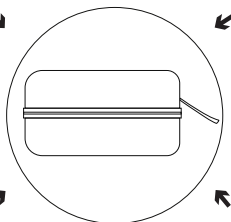

Carry Case

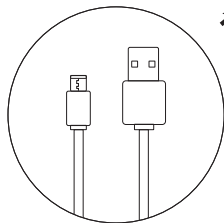

Type-C Charging Cable



User Manual

Detailed Function Parameters ∨

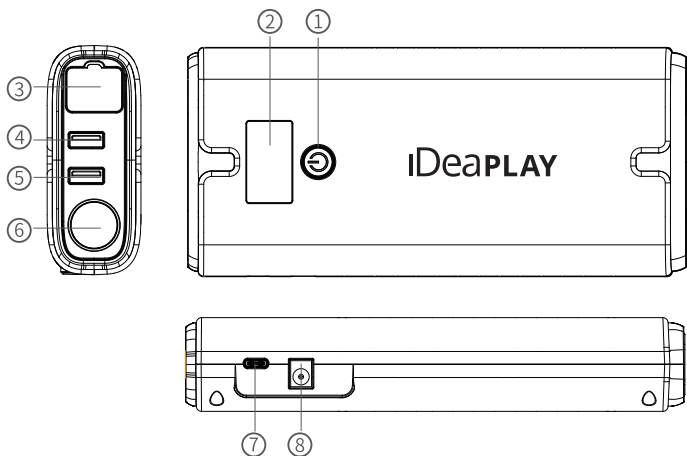

1. Power Button
2. LED Display
3. Smart Clamp Jump Cable Port
4. Output 1

5. Output 2
6. LED Light
7. Power Input
8. DC Output Port

Product Parameters

Model:	J10
Dimensions:	191x88x36mm (7.5X3.4X1.4inch)
Weight:	525g (18.5 oz)
Battery Capacity:	18000mAh, 66.6Wh
Output 1, USB :	5V/3.A, 9V/2A, 12V/1.5A
Output 2, USB:	5V/2.1A
Input Type-C:	5V/2A
DC Output:	12V/10A
Start Current:	750A
Peak Current:	1500A
Operating Temperature Range :	0°C to 45°C (32°F to 113°F)
Storage Temperature Range:	-5°C to 45°C (23°F to 113°F)

LED Display

USB 1 (QC 3.0):	The USB QC output port is active
USB 2:	The USB output port is active.
% Power Display:	Power Remaining.
Battery Indicator:	Last digit of the percentage will flash.



Charging the Jump Starter ✓

Step 1

To charge the J10 jump starter use the USB lead included. Insert the USB cable into the USB Type-C input port (7) of the jump starter

Step 2

Use an adapter to connect the jump starter to a power source. A plug adapter is not included in the package.

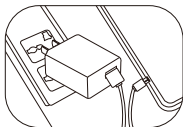

Note:

You can charge the J10 Jump starter from USB power sources such as a laptop or PC.

⚠ Caution:

Don't charge the J10 jump starter immediately after using it to jump start a car or while it is still hot.

Jump Starting a Vehicle ✓

If an automobile does not start on its battery, this portable jump starter can apply sufficient charge to aid you in jump starting the vehicle.

The J10 Portable Jump Starter can be used to jump-start an automobile if the vehicle's battery is dead.

⚠ Caution:

Ensure the vehicle is in park (for automatic transmission) or neutral (for manual transmission), and the parking brake applied. Ensure the J10 jump starter's power level is 60% or more.

Step 1

Connect the 12V smart clamp cable into the J10 jump starter. If connected correctly, the LED on the lead flashes red and green alternately.

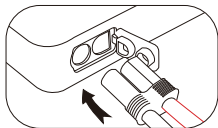

Step 2

Connect the 12V smart clamp cable to the vehicle, first connect the red (positive) clip to the (+) battery terminal. Then connect the black (negative) clip to the (-) battery terminal.

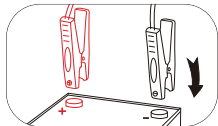

Step 3

The LED light on the smart clamp cable is green if the clips are correctly connected, and the J10 jump starter has sufficient charge. Proceed to step 4. If the LED light on the smart clamp cable is red, please disconnect the leads from the J10 jump starter and start again from step 1.

Step 4

If the LED light on the smart clamp cable is green, turn the ignition key or press the ignition button to start the vehicle. After 30 seconds, if you have not started the vehicle, the LED light on the battery clip lead turns red.

If starting the vehicle is unsuccessful, the LED light on the smart clamp cable turns red.

If the LED is red, please disconnect the smart clamp cable from the J10 jump starter and start again from step 1.

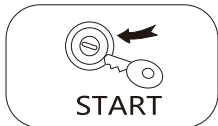

Step 5

After successfully starting the vehicle, wait 30 seconds until the LED light on the smart clamp cable has turned red. Remove the power lead from the battery pack then remove the clamps from the battery.

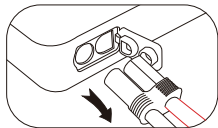

Charging Electronic Devices ∨ with the USB Ports

Step 1

Choose a suitable charging cable and insert the cable into the USB output port 1/2.

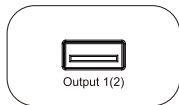

Step 2

Insert the other end of the cable into the input port of the product you wish to charge.

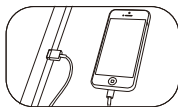

Step 3

Press the power button (1) to start charging your electronic device.

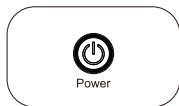

Note

After 10 seconds, if no charging device is detected, the J10 jump starter automatically powers off.

Charging Electronic Devices ∨ with the DC Output

Step 1

Choose a suitable charging cable and insert the cable into the DC output port of the jump starter.

Step 2

Insert the other end of the cable into the input port of the product you wish to charge.

Note

If the over-current or short-circuit protection is activated (neither display nor power button works), you need to charge the J10 before it can be used again.

Using the Flashlight

The J10 Jump Starter has a built-in LED flashlight.

Operating instructions:

The LED flashlight has 3 modes, On, SOS, and Strobe.

a. Turn on

To turn on the LED flashlight, press and hold the power button for 3 seconds.

b. Change light modes

To cycle between the different lighting modes, press the power button.
(Bright/SOS/Strobe)

c. To turn off

To turn off the LED light press and hold the power button for 3 seconds.

Notice

1. Always use the original charger for charging.
2. Never overload the current and voltage, or it may cause discharge, physical, or safety issues with the battery cell.
3. Recharge the battery at least every 3 months to make sure it works correctly.
4. Avoid exposing the battery pack to heavy knocks or blows.
5. Never expose the battery pack to water.
6. Never put near a heat source or close to fires.
7. Never remove or attempt to modify the battery pack.
8. If the battery becomes inflated, leaks, or has a peculiar smell, please stop using it at once.
9. Please follow the operating manual to connect the clamps correctly.
10. Please don't start the car continuously. If you try to start the car without success, please wait 30 seconds before trying again.
11. When the battery power of the unit is under 60%, please do not attempt to jump start a vehicle.
12. If the battery pack heats up after using, please wait for at least 10 minutes before charging it.
13. DO NOT charge the product immediately after use or while it is still hot.
14. DO NOT allow the metal teeth of the red clamp to touch the metal teeth of the black clamp.
15. Never burn or incinerate this product because it may explode and generate toxic fumes and other potentially harmful chemicals.
16. Never insert foreign objects into any input or output ports because it may cause a short circuit which can damage the battery and even cause fire and personal injury.

Warning:

- a. Do not overcharge the internal battery ---See Instruction Manual.
- b. Do not smoke, strike a match, or cause a spark in the vicinity of the power pack
- c. Only charge the internal battery in a well ventilated area.
- d. Risk of Injury To Persons. Do not use this product if the output cord or device are damaged in any way.
- e. This device is not intended for use in a commercial repair facility.

FCC Statement

This equipment has been tested and found to comply with the limits for a Class B digital device, pursuant to Part 15 of the FCC Rules. These limits are designed to provide reasonable protection against harmful interference in a residential installation. This equipment generates, uses and can radiate radio frequency energy and, if not installed and used in accordance with the instructions, may cause harmful interference to radio communications. However, there is no guarantee that interference will not occur in a particular installation. If this equipment does cause harmful interference to radio or television reception, which can be determined by turning the equipment off and on, the user is encouraged to try to correct the interference by one or more of the following measures:

- Reorient or relocate the receiving antenna.
- Increase the separation between the equipment and receiver.
- Connect the equipment into an outlet on a circuit different from that to which the receiver is connected.
- Consult the dealer or an experienced radio/TV technician for help.

This device complies with Part 15 of the FCC Rules. Its operation is subject to the following two conditions: (1) This device may not cause harmful interference, and (2) this device must accept any interference received, including interference that may cause undesired operation.

FCC Caution: Any changes or modifications not expressly approved by the party responsible for compliance could void the user's authority to operate this equipment.

Portable Jump Starter J10